

REVISIONS				
ECN	REV.	DESCRIPTION	DATE	APPROVED
	A	RELEASED	2014-09-19	CMB
	B	ADDED SHADED PART IMAGE	2014-09-23	CMB
	C	REMOVED DOUBLE IMAGES	2014-10-13	CMB

HALEX PART #	TRADE SIZE	A ±0.03	B ±0.03	C ±0.03	XX"
60705YIN	1/2"	1.078	0.359	0.913	1/2"
60707YIN	3/4"	1.250	0.313	1.135	3/4"
60710YIN	1"	1.500	0.344	1.385	1"
60712YIN	1-1/4"	1.818	0.313	1.755	1 1/4"
60715YIN	1-1/2"	2.219	0.359	2.011	1 1/2"
60720YIN	2"	2.688	0.375	2.500	2"

APPLICATION:

- INDOORS. USE TO COVER EXPOSED KNOCK-OUT HOLES IN STEEL OUTLET BOXES AND OTHER METAL ENCLOSURES

CERTIFICATIONS:

- TO UL AND cUL REQUIREMENTS

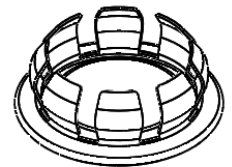

PART TYPE CATEGORIES: +ACC	CRITICAL CHARACTERISTIC	THIRD ANGLE PROJECTION 	MATERIAL: Alloy Steel	<table border="1"> <tr> <th></th> <th>NAME</th> <th>DATE</th> </tr> <tr> <td>DRAWN</td> <td>M.BIVENS</td> <td>2014-09-19</td> </tr> <tr> <td>CHECKED</td> <td>S.CICCONE</td> <td>2014-09-19</td> </tr> <tr> <td>ENG APPR.</td> <td></td> <td></td> </tr> <tr> <td>MFG APPR.</td> <td></td> <td></td> </tr> </table>		NAME	DATE	DRAWN	M.BIVENS	2014-09-19	CHECKED	S.CICCONE	2014-09-19	ENG APPR.			MFG APPR.			 HALEX <small>BEYOND THE CURRENT</small> a Scott Fetzer company	7715 HOMESTEAD DR. HAMILTON, IN 46742 PHONE: 260.448.3531 FAX: 260.448.3642
				NAME	DATE																
DRAWN	M.BIVENS	2014-09-19																			
CHECKED	S.CICCONE	2014-09-19																			
ENG APPR.																					
MFG APPR.																					
FINISH: ZINC ELECTRO-PLATE, CLEAR	REFERENCE YIN 63001-63006 MASS: _____ lbs REMOVE ALL BURRS AND SHARP EDGES VOLUME: _____ cu.in.	DESCRIPTION: KNOCK OUT SEALS, STEEL																			
PROPRIETARY AND CONFIDENTIAL THIS DRAWING DISCLOSES PROPRIETARY AND CONFIDENTIAL INFORMATION WHICH IS THE PROPERTY OF HALEX/SCOTT FEIZER COMPANY AND IT MAY NOT BE REPRODUCED IN WHOLE OR IN PART WITHOUT THE EXPRESS WRITTEN PERMISSION BY HALEX/SCOTT FEIZER COMPANY. THE DRAWING HAS BEEN SUBMITTED UNDER A CONFIDENTIAL RELATIONSHIP FOR A SPECIFIC PURPOSE. THE RECIPIENT AGREES BY ACCEPTANCE NOT TO DISCLOSE ANY INFORMATION CONTAINED HEREIN TO ANY UNAUTHORIZED PERSONS OR ORGANIZATIONS, OR TO USE THE DRAWING FOR ANY OTHER PURPOSE. ALL PATENT RIGHTS HERETO ARE EXPRESSLY RESERVED BY HALEX/SCOTT FEIZER COMPANY.		UNLESS OTHERWISE SPECIFIED: DIMENSIONS ARE IN INCHES TOLERANCES: SEE TABULATION NOTES	SCALE: NONE	DO NOT SCALE DRAWING	SHEET 1 OF 1																